

Pacific Logistic Terminal

Logistic provider of Sollers group at Russia Far East



Pacific Logistic Terminal

About port



- Pacific Logistic Terminal providing services to commodity flows, including the following for the Far Eastern automotive manufacturing that are part of the SOLLERS group.
- SOLLERS Group has a production and logistics complex with port infrastructure, it includes the Mazda industrial assembly, and production capacities are being built for the production of SkyActive-G series engines for their further export to Japan.

Pacific Logistic Terminal

About port



- PLT provide all services required on a open market today , such as handling and transportation.
- The main cargo flow are going by Import from China, South Korea, Japan and Malaysia
- Main shipping lines today along PLT are Sinokor / MCC / APL

Pacific Logistic Terminal Location

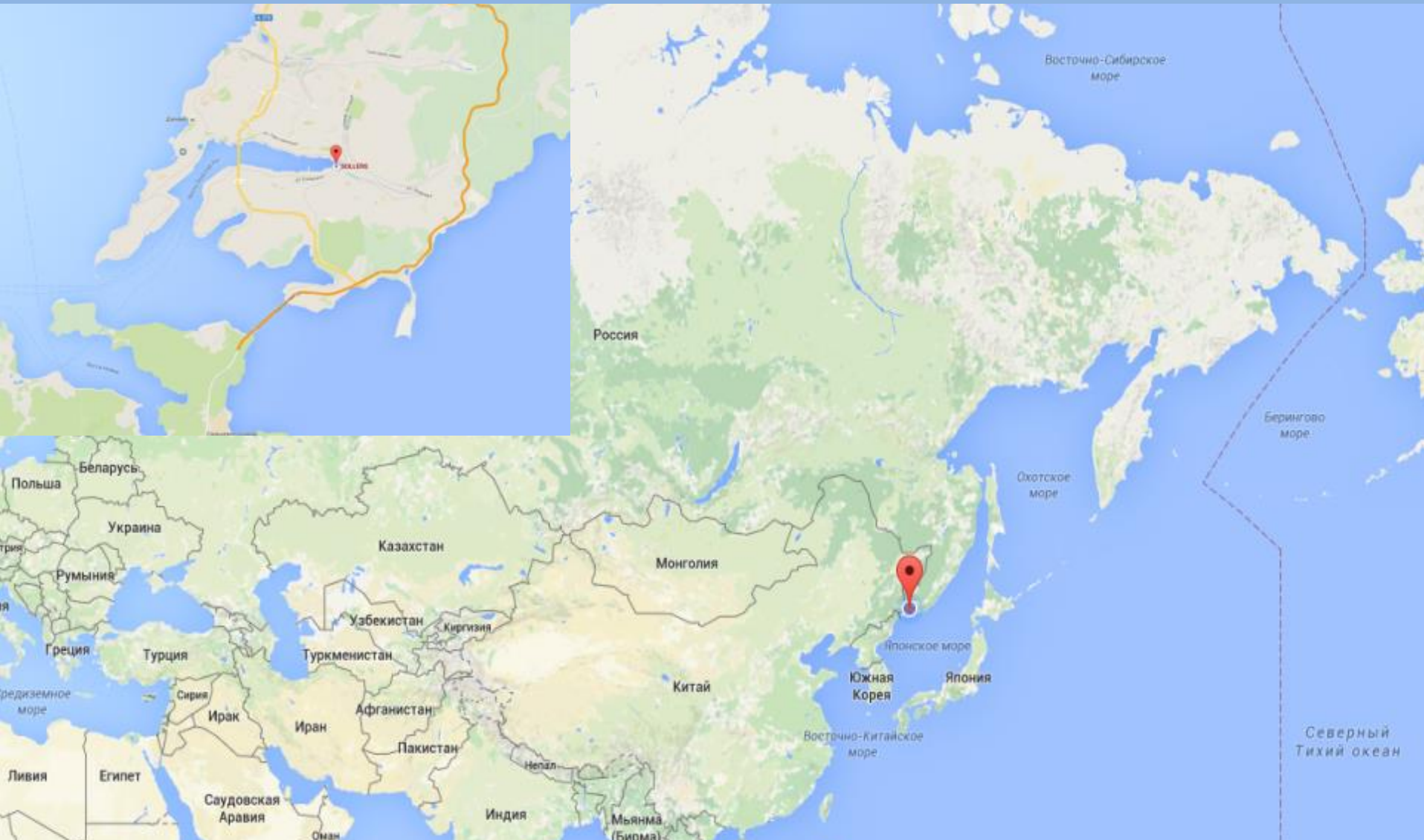

- Located on Russia Far East, Vladivostok Port, top of Golden Horn Bay.
- PLT owned by CY within industrial area of Sollers group.

Pacific Logistic Terminal Port Facilities



<u>Berth & ships characteristics</u>		<u>Open storage area</u>	
Berth length	150,0m	Capacity	5 000TEU
Depth alongside	8,0m	Warehouse space	50 000sqm
Ship's main particulars		Reefer plugs	100units
LOA	148,0m	IMDG classes	2, 3, 4, 5, 6, 8, 9
Maximum draft	7,5m		

Pacific Logistic Terminal Equipment

Cargo handling equipment

Portal crane

Gottwald	
Load-lifting capacity	79 mt
Number	1 unit
Crane performance	22 moves/hr
KPM 32/16	
Load-lifting capacity	32/16 mt
Number	1 unit

RTG crane

Kalmar	
Load-lifting capacity	45 mt
Number	3 units

RMG crane

Baltkran	
Load-lifting capacity	45 mt
Number	1 unit

Reach staker

Kalmar	
Load-lifting capacity	45 mt
Number	5 units

Terminal tractor

Kalmar	
Number	5 units



Railway wagon loading/unloading

Shunting diesel locomotive

TGM-6	
Number	2 units
	Handling area
#9	
Length	385,1 m
Capacity	27 wagon
#10	
Length	385,1 m
Capacity	27 wagon
#11	
Length	407,8 m
Capacity	29 wagon

Pacific Logistic Terminal Railway



Current route-schedules to the following directions:

Moscow; Novosibirsk; Ulianovsk; Toliatty; Grodekovo; St. Petersburg; Irkutsk.

PLCT is connected directly to TSR – Gaydamak Station is located 1 mile away from CY.

PLCT provides handling cars, containers, general cargo, both dangerous (IMDG classes 2-6,8) and non-dangerous

2 separated loading areas for loading containers & cars business. Total capacity – 126 wagons.

Dispatching 5 Block Trains on weekly basis to Moscow, Novosibirsk and Ulyanovsk district.

Pacific Logistic Terminal Cargo flow



- DKD units for automotive assembly Mazda Sollers Manufacturing Rus (Far East) in Vladivostok and Isuzu in Ulyanovsk (Volga region) following the principle of just-in-time
- CBU cars produced under the Mazda brand in Vladivostok, as well as new imported cars Isuzu, Subaru, etc.
- Common consumption goods staffed into containers, following from Asia to Moscow hub, to Siberia and to the Volga region

Pacific Logistic Terminal Development 2019-2021

Investments for next three years:

- Two berths for 1700-3000TEU-vessels
- CY capacity up to 9000 TEU.
- Investments to requirement port equipment

Join new territory

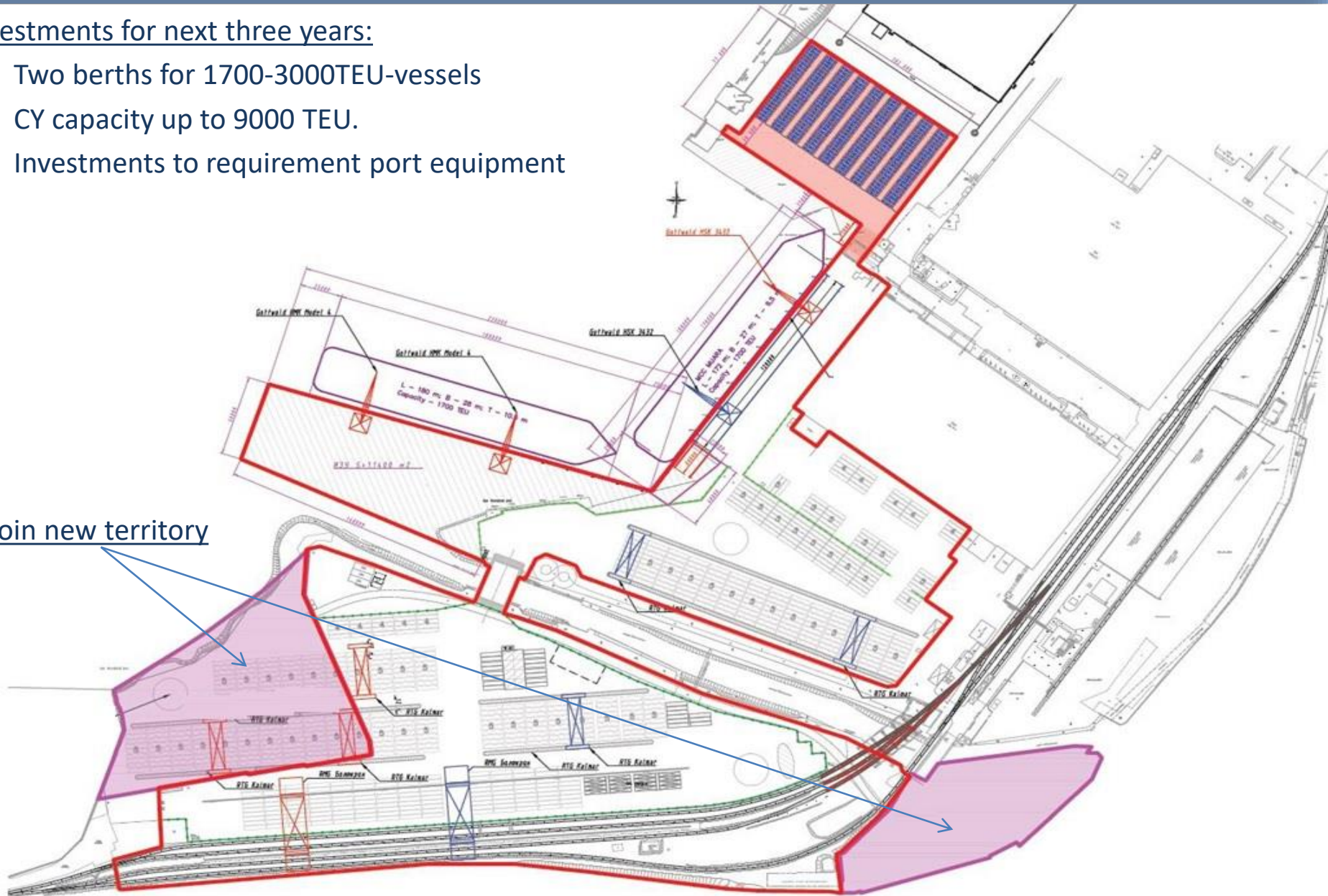

Pacific Logistic Terminal Development 2019-2021

	2018 г.	2018-2019 г. (1 stage)	2020 г. (2 stage)	2021 г. (3 stage)
Length of Berth , m	150	150	205	215(+230 sec. berth)
Depth of approaching channel and CY	7,5	8,3	8,8	9,3
Ship's LOA	148	148	170	180
Vessel's Draft	6,8	7,5-8,0	9,5	9,5
Capacity, TEU	1000	1200-1700	1700	2000
DWT, tonn	13 800	15 000	21 000	23 000

Pacific Logistic Terminal

Thank you for attention



690001, Vladivostok, 2, Dalzavodskaya Str.
phone: (423) 252-92-90
info@pacific-logistic.ru
www.Pacific-logistic.ru